

Your guide to making a text relay call



You can make a text relay call using the NZ Relay app. This is where you can type a message which will be passed on to another person by a Relay Assistant. The Relay Assistant will then type their response for you to read.

Please note that all text relay calls are confidential.

Steps to making a text relay call

- 1 Tap on the NZ Relay app on your home screen to open it.

If this is the first time you are using the app, you will see a welcome screen. Follow the on-screen prompts to read and accept the Terms and Conditions.

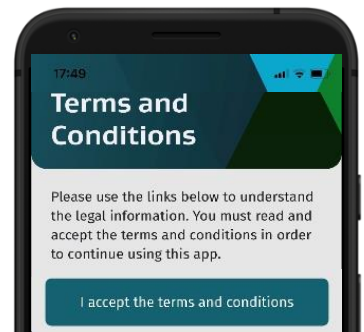

You will then be taken to the 'Make a relay call' screen.

- 2 Choose the 'Text Relay' option from the drop down menu.

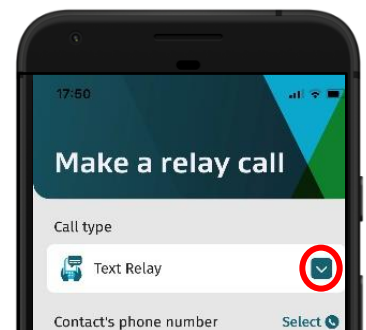

- 3** To enter the phone number of the person you would like to call, you can:
- Tap the 'Contact's phone number' field and enter the number.
 - Tap on 'Select' to open your contact list. Tap the contact you would like to call.

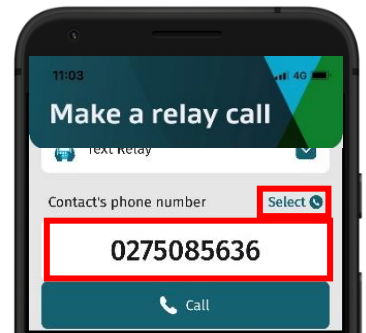

- 4** Tap the 'Call' button.

You will now be connected to NZ Relay. Follow the instructions on your chat screen.

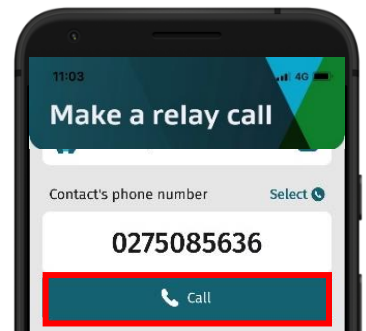

- 5** Once you have been greeted by the Relay Assistant, you can begin typing your message.

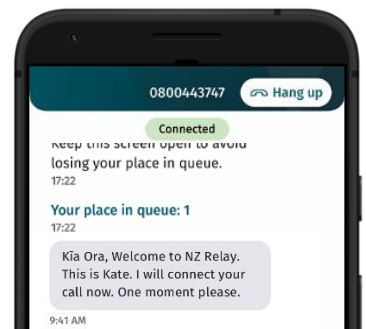

- 6** When you are finished typing your message, end with the letters 'GA.'

This stands for 'go ahead,' and indicates to the Relay Assistant that your message is ready to be passed on.

The Relay Assistant will voice your message to the person you are calling and type their reply back to you.

This will appear on the chat screen.

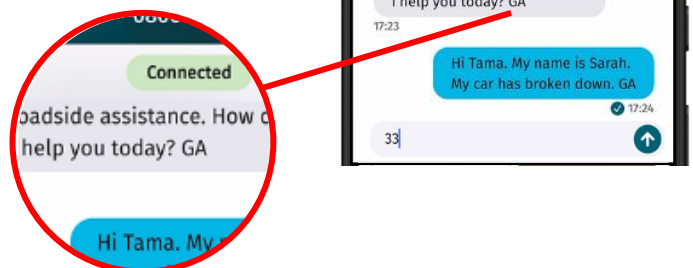

- 7 When you're ready to hang up, tap the 'Hang up' button.

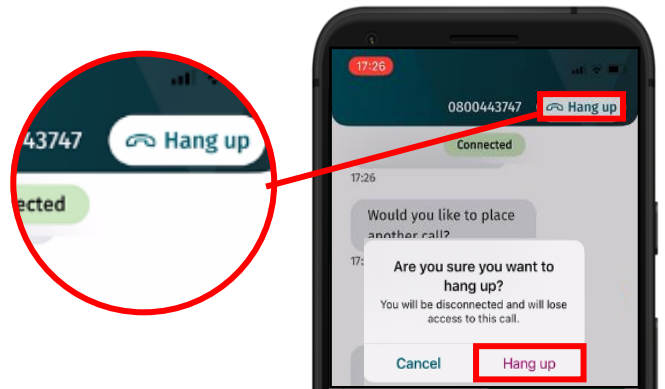

- 8 You will be given the option to save your conversation. If you want to do this, tap 'Save conversation' and choose from the options available on your device.

Once you close the chat screen, this option will no longer be available.

If you don't want to save your conversation, simply close the chat screen.

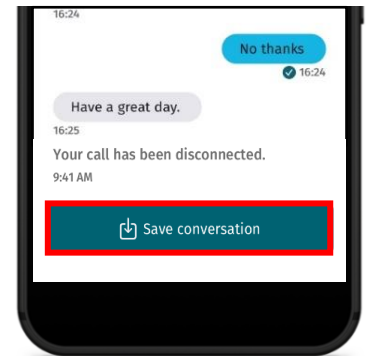

Check out www.nzrelay.co.nz for more information and resources.

If you are concerned about following this guide on your own, please contact our Help Desk team. We are here to help and will provide the tailored support and assistance that you need to feel confident using this service.



Contact us

TTY 0800 4 713 713 Voice 0800 4 715 715 Fax 0800 4 329 697
Help Desk email helpdesk@nzrelay.co.nz

NZ Relay is supported and funded by the New Zealand Government through the Ministry of Business, Innovation and Employment (MBIE).



**MINISTRY OF BUSINESS,
INNOVATION & EMPLOYMENT**
HĪKINA WHAKATUTUKI

New Zealand Government